

# FULLDOME 360° - 10 METERS - 80 SQM

Multiple uses - conferences, meetings, events, lectures, workshops  
 Quick assembly & configuration  
 Adaptable to various sites

- FULLY IMMERSIVE 360° EXPERIENCE
- INDOOR & OUTDOOR USE
- RENT OR BUY OPTIONS
- LARGE RENTAL FLEET AVAILABLE
- PORTABLE SOLUTION
- COMPATIBLE WITH VR GOOGLES
- RENT OR BUY OPTIONS
- WINDPROOF
- WATERPROOF
- SNOW-RESISTANT
- 4 SEASON OPERATION
- UP TO A 10 YEAR WARRANTY



• FULLY IMMERSIVE 360° INTERIOR, WITH PROJECTION LINER

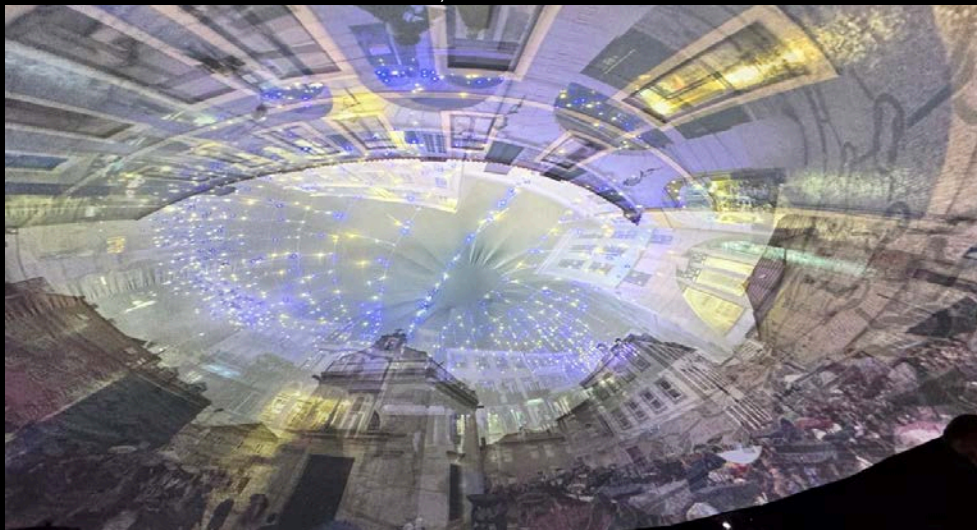

UNIVERSITY OF AVEIRO, PORTUGAL

• EXTERIOR PVC COVER ALLOWS FOR BRANDING OPTIONS



GOVERNMENT OF QUERÉTARO, MÉXICO - DOMO CONÉXION, MADRID, SPAIN

• INTERIOR PROVIDES AN IMMERSIVE EXPERIENCE FOR EACH USER

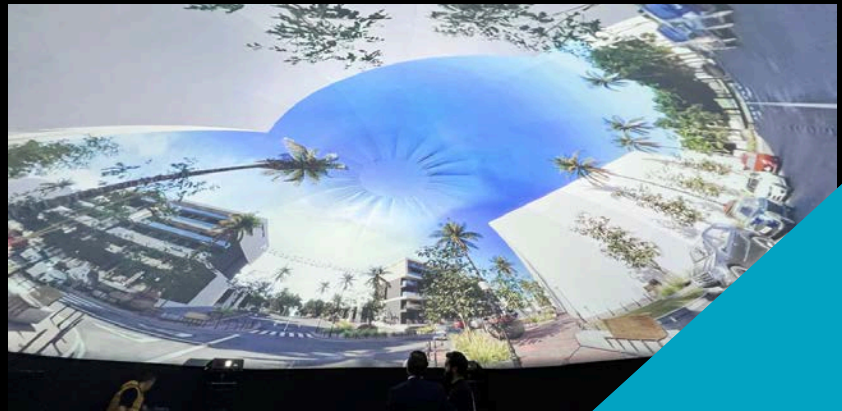

LAGOOM LIVING EXPERIENCE - MÁLAGA, SPAIN

**AXONOMETRIC VIEW WITH LIST OF COMPONENTS**

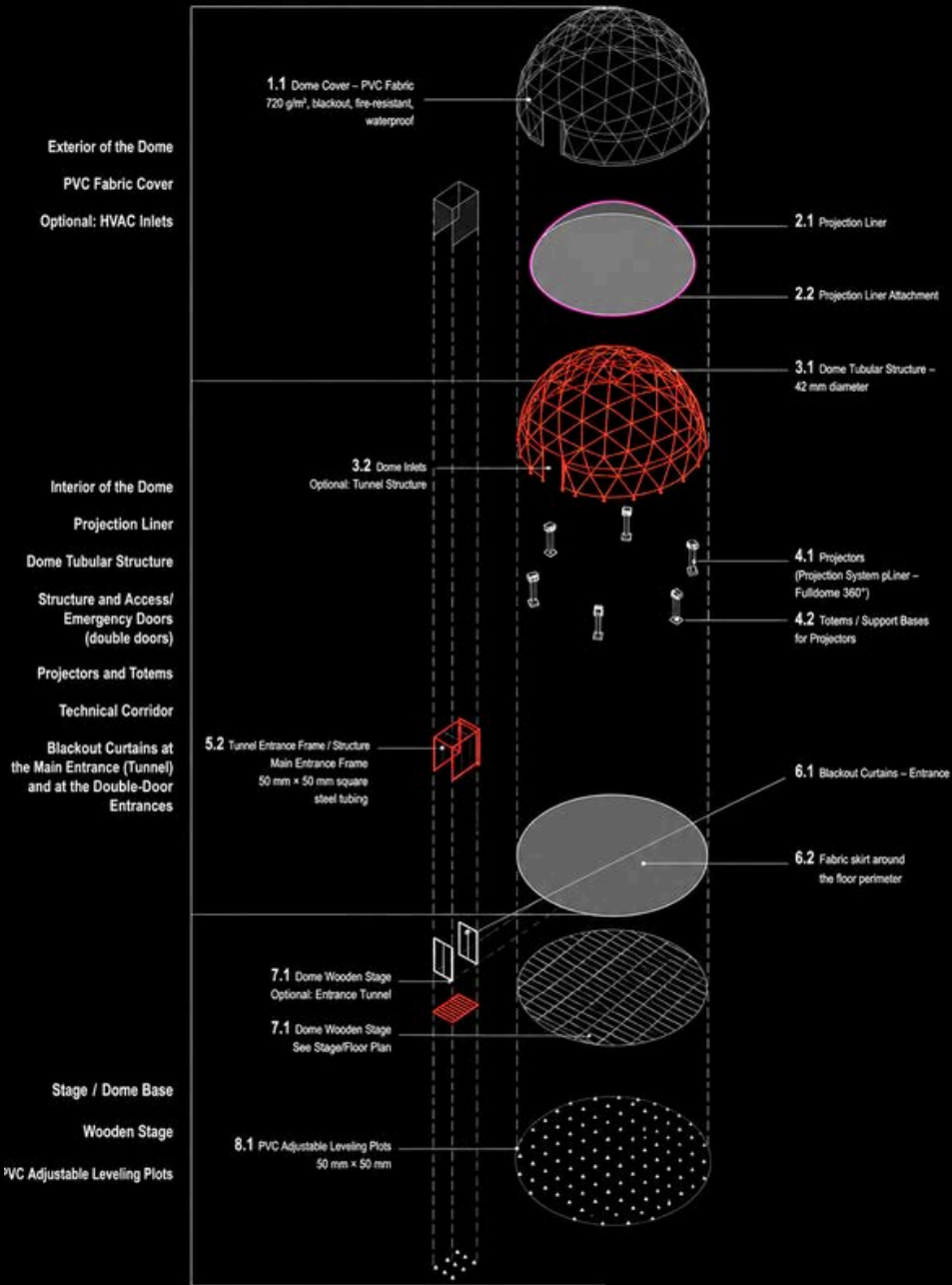

**FLOOR PLAN - FULLDOME 10M**

POSSIBILITY OF CONFIGURING INTERACTIVE EXPERIENCES USING 360° VR GOGGLES.  
MULTIPLE USES FOR THE SPACE (CONFERENCES, EXHIBITIONS, EVENTS, SPORTS...)

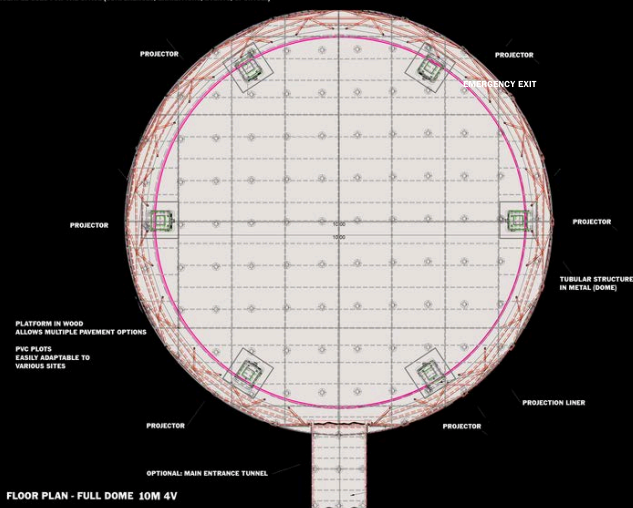

**FLOOR PLANS SHOWCASING FLEXIBILITY OF THE DOME & MULTIPLE TYPES OF USES**

**CONFERENCES - CENTRAL STAGE**



**CONFERENCES**



**WORKSHOP - CREATIVE**



**COOKING WORKSHOP**



· 3D MODELLING AND 3D RENDERING SERVICES TAILORED TO EACH CLIENT'S REQUIREMENTS



**FULLDOME 10m | 80m<sup>2</sup>**  
 Geodesic Steel Structure  
 Blackout PVC Exterior Cover  
 360° Projection Liner  
 Ventilation & Stabilization System  
 Technical Perimeter Curtain  
 Double Fire-Rated Doors

**52.813,60€**

**INSTALLATION SERVICES**

Complete Dome Assembly  
 Projection Liner Installation  
 Ventilation System Setup  
 Technical Curtains  
 Equipment Support Structures  
 All Tools & Installation Equipment Included

**5.250,00€**

**FOUNDATIONS, PLATFORM & FLOORING**

Cement-Free Ground Screw Foundations  
 Levelling Platform  
 Elevated Wooden Deck  
 Floating Vinyl Flooring  
 Waterproof Finish & Skirting

**30.400,00€**

**TOTAL TURNKEY SOLUTION**

**88.463,60€**

All prices are exclusive of VAT and do not include installation crew expenses or transportation costs related to the personnel and equipment/materials proposed.

